



ESPLOSI RICAMBI
SPARE PARTS

GCP ELETTRICI IRRORAZIONE VR. ARAG

UNIGREEN® S.p.A.
via Rinaldi, 105 - 42100 REGGIO EMILIA - ITALY
Tel. (0039) 0522 369811 - Fax. (0039) 0522 369898
e-mail: info@unigreen-spa.com - www.unigreen-spa.com
member of the YAMA group



UNACOMA MEMBER

Sommario

Dx-Sx Elettrico 40 Bar Laser-Futura VR.ARAG / Electric Dx-Sx 40 Bar	3
GCPE 40Bar 2V Laser-Futura Vr. ARAG / GCPE 40 Bar 2V	4
GCP 2 VIE Elettrico 10 Bar Airdrop ARAG / Pressure regulator.....	5
GCPE 4V Elettrico 10 Bar Airdrop ARAG / Pressure regulator.....	6
GCPE 2 Vie Elettrico 30 BAR T.T. ARAG / Pressure regulator	7
GCPE 4 Vie Elettrico 40 bar T.T. ARAG / Pressure regulator	8
R465513 Valvola regolazione max pressione / pressure relief control valve	9
R463083 Valvola regolazione max pressione / Pressure relief control valves	10
R463070 Valvola Regolazione proporzionale / Propotional control valve	11
R463051 Valvola sezione barra / Boom section valves	12
R463001HS Valvola di sezione barra / Boom section valves	13
R463024 Valvola regolazione proporzionale / Proportional control valve	14
R3269013 Filtro linea Flangiato Serie 463 / Flanged line filter for 463 series	15
R345200350 Filtro linea flangiato alta pres. s.463 / Flanged hight pres. line filter for 463 s.	16
R463011S Valvola sezione barra / Boom section valves	17
Ritorni calibrati Arag / Metered by-pass.....	18
Attacchi per valvole / Valve Connectors	19
Attacchi e kit assemblaggi valvole / Connectors and kit assembly metered by-pass valve	20
R466152 Pulsantiera 2 interruttori / Control panel 2 switch.....	21
26100053F Pulsantiera 2 Sez. Press. Cavo.4 m / Control panel 2 Sez. Press. Cable 4 m.....	22
26100054F Pulsantiera 4 Sez.Press.Gen.Cavo.4 m / Control panel 4 Sez.Press.Gen.Cable 4 m	23

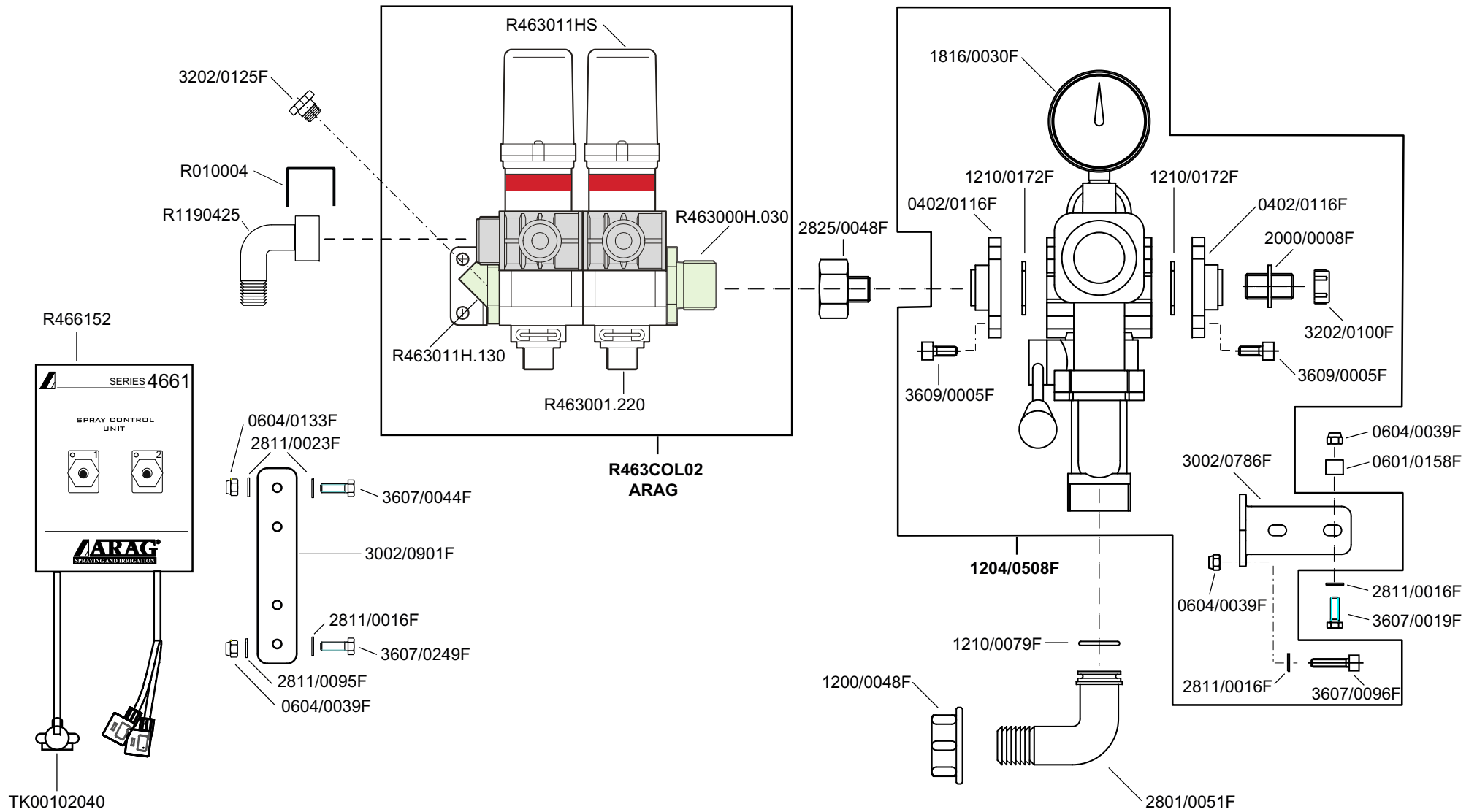

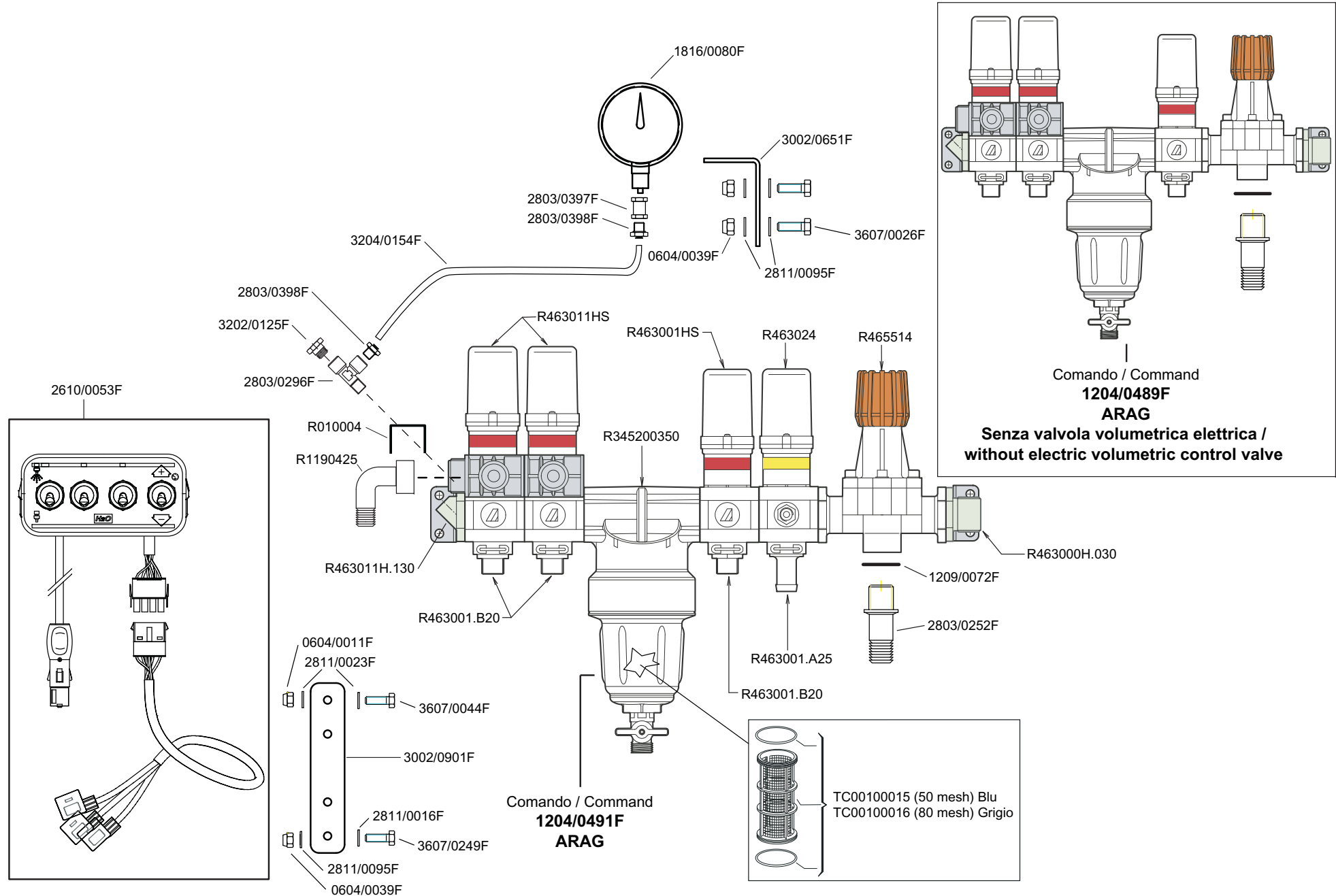

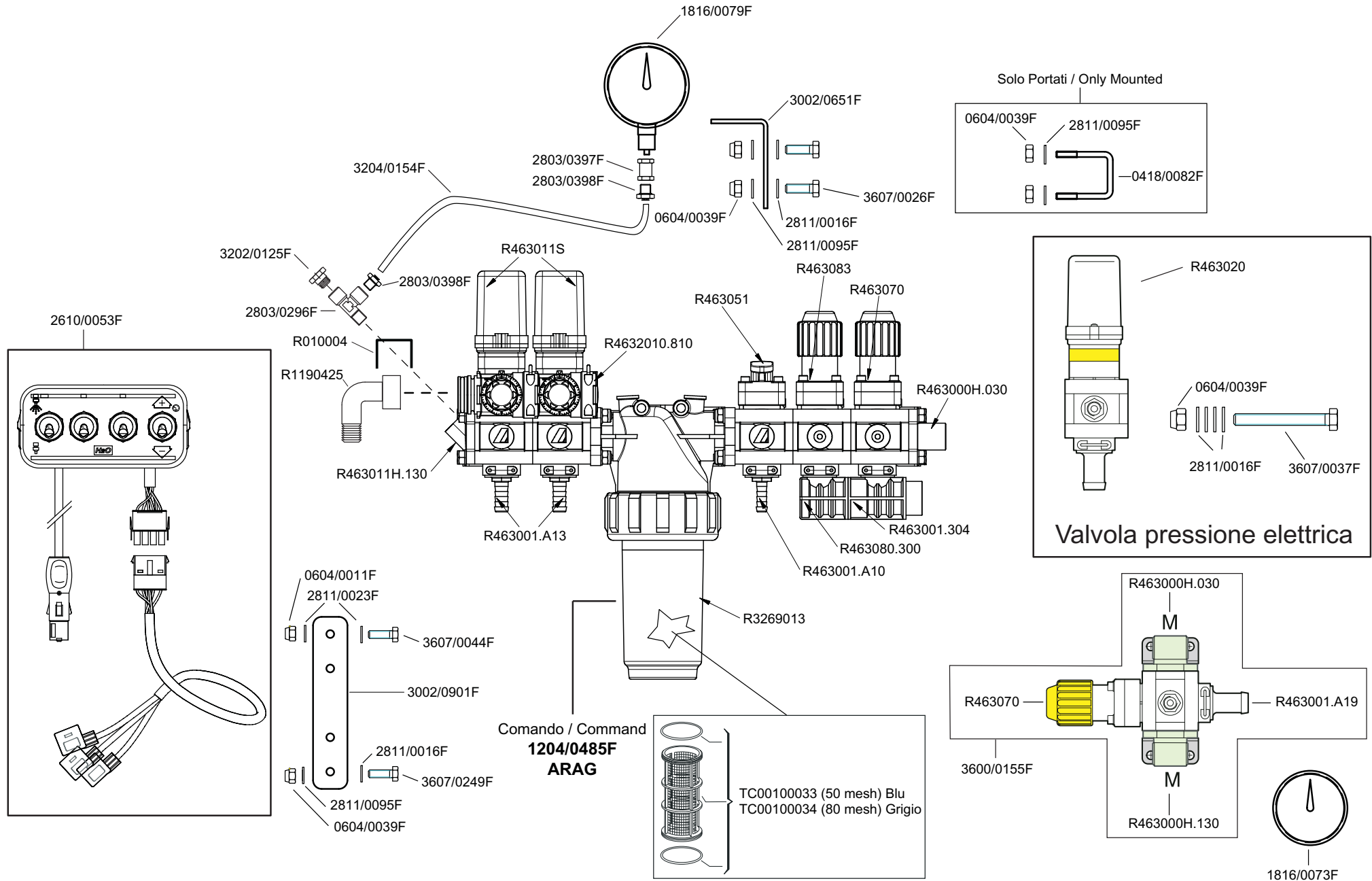

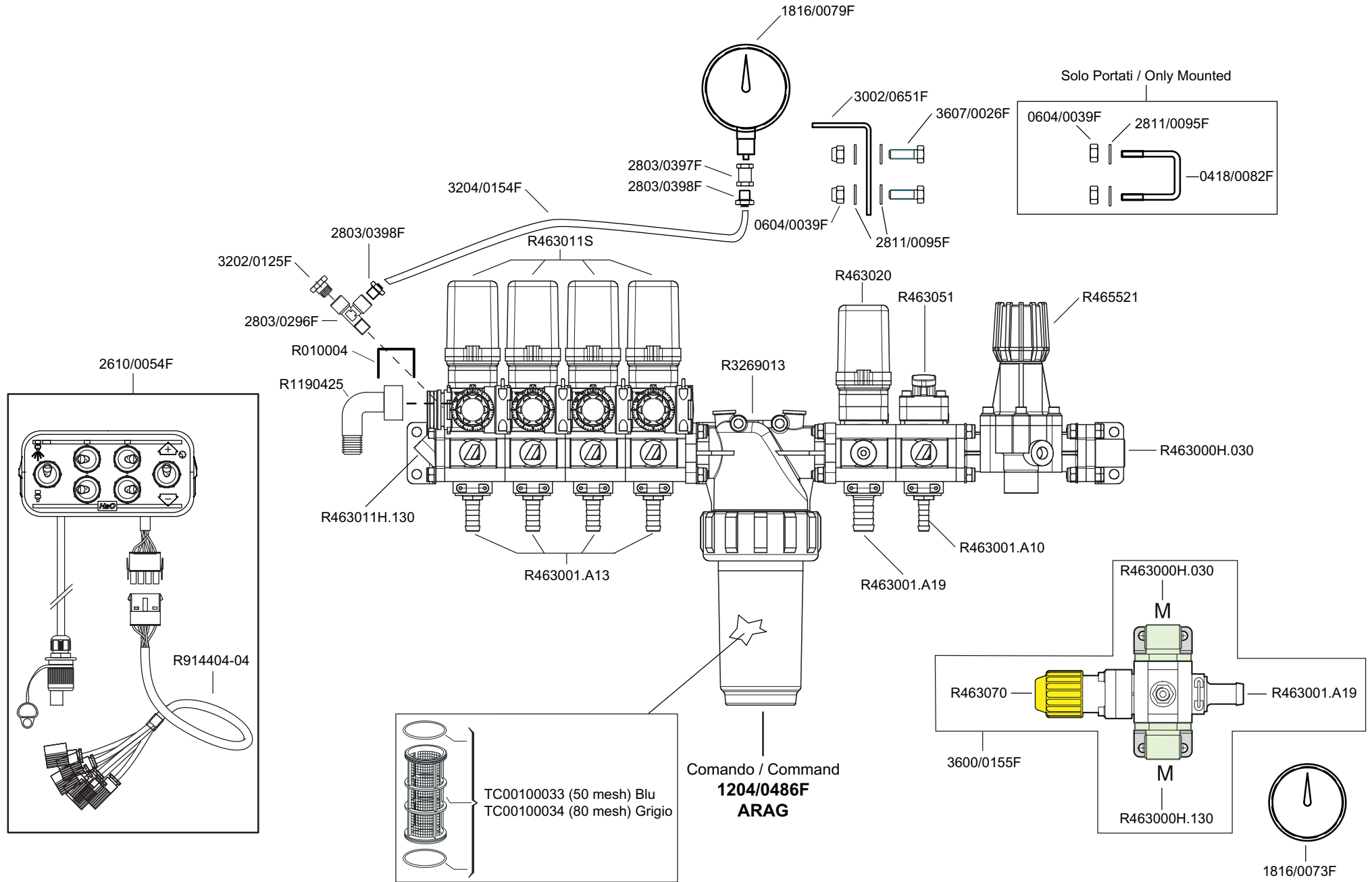

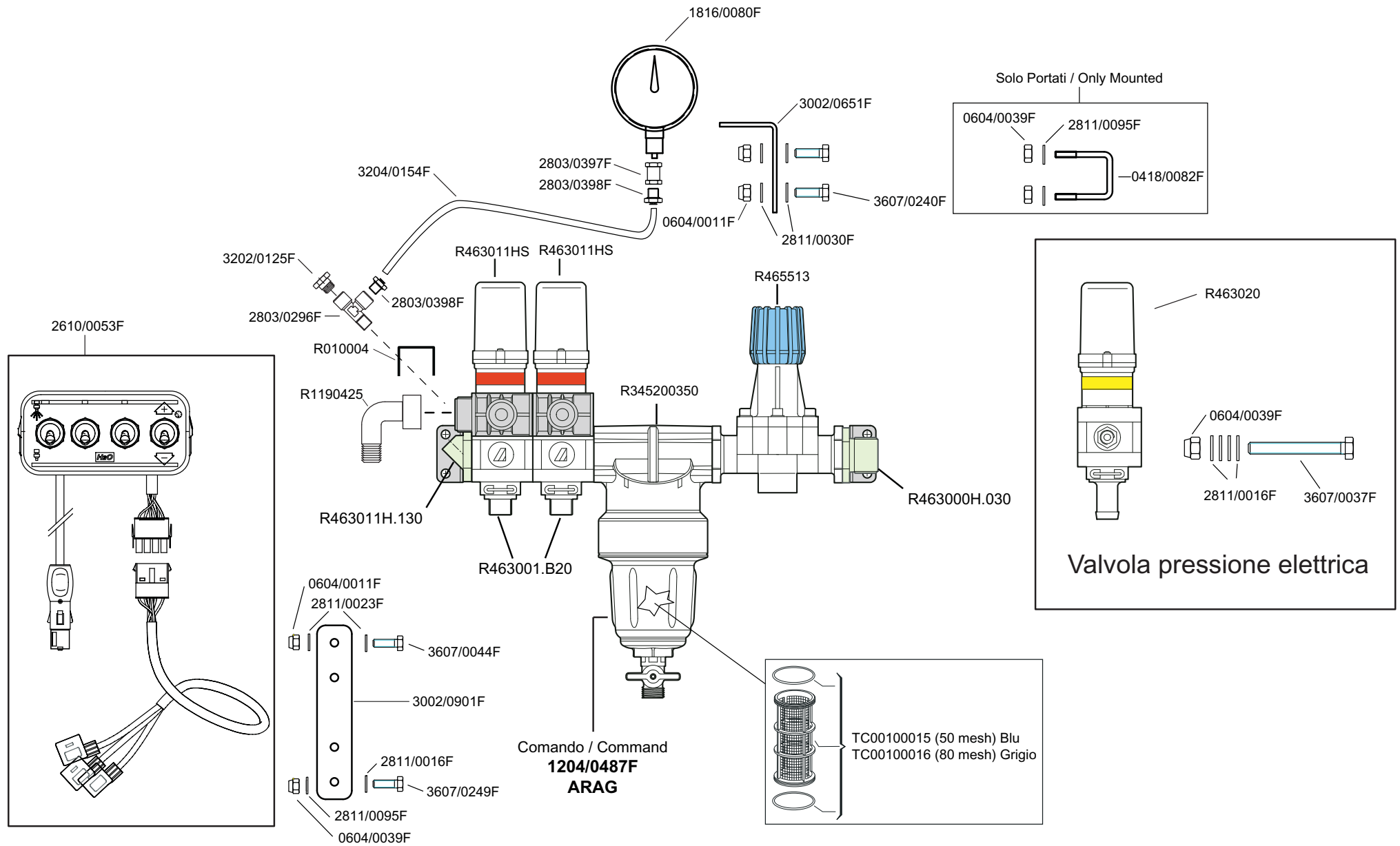

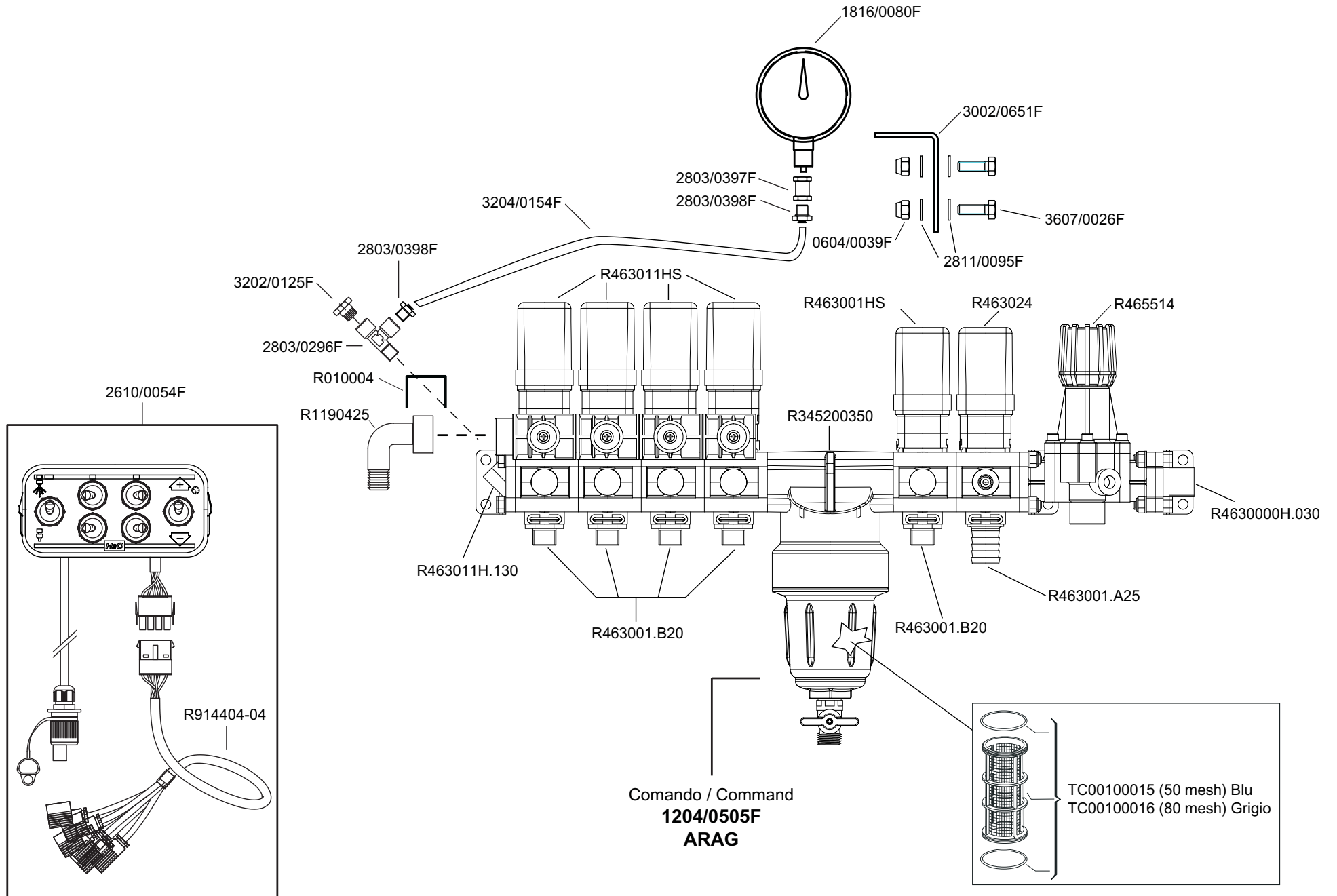

A2 SECTION	TAVOLA 18	COD R465513 - R465514 - R465521 - 465522
	VALVOLE DI REGOLAZIONE MASSIMA PRESSIONE - PRESSURE RELIEF CONTROL VALVES VALVULAS DE REGULACION MAXIMA PRESSION - VANNES DE REGLAGE PRESSION MAXIMUM HÖCHSTDRUCKREGELVENTILE - VÁLVULAS DE REGULAGEM DA PRESSÃO MÁXIMA	
		SERIES 465

46551x-52x

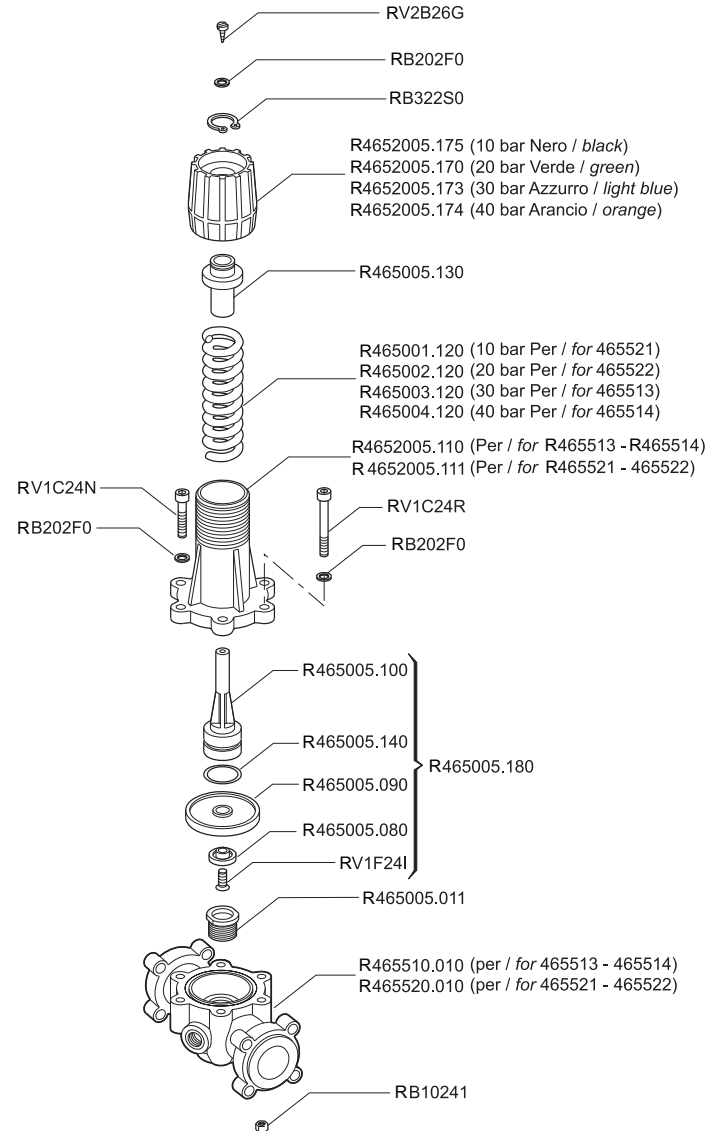

A2 SECTION	TAVOLA 16	463080 - 463081 - 463082 - R463083
	VALVOLE DI REGOLAZIONE MASSIMA PRESSIONE - PRESSURE RELIEF CONTROL VALVES VALVULAS DE REGULACION MAXIMA PRESION - VANNES DE REGLAGE PRESSION MAXIMUM HÖCHSTDRUCKREGELVENTILE - VÁLVULAS DE REGULAGEM DA PRESSÃO MÁXIMA	
		SERIES 463

463080-m03

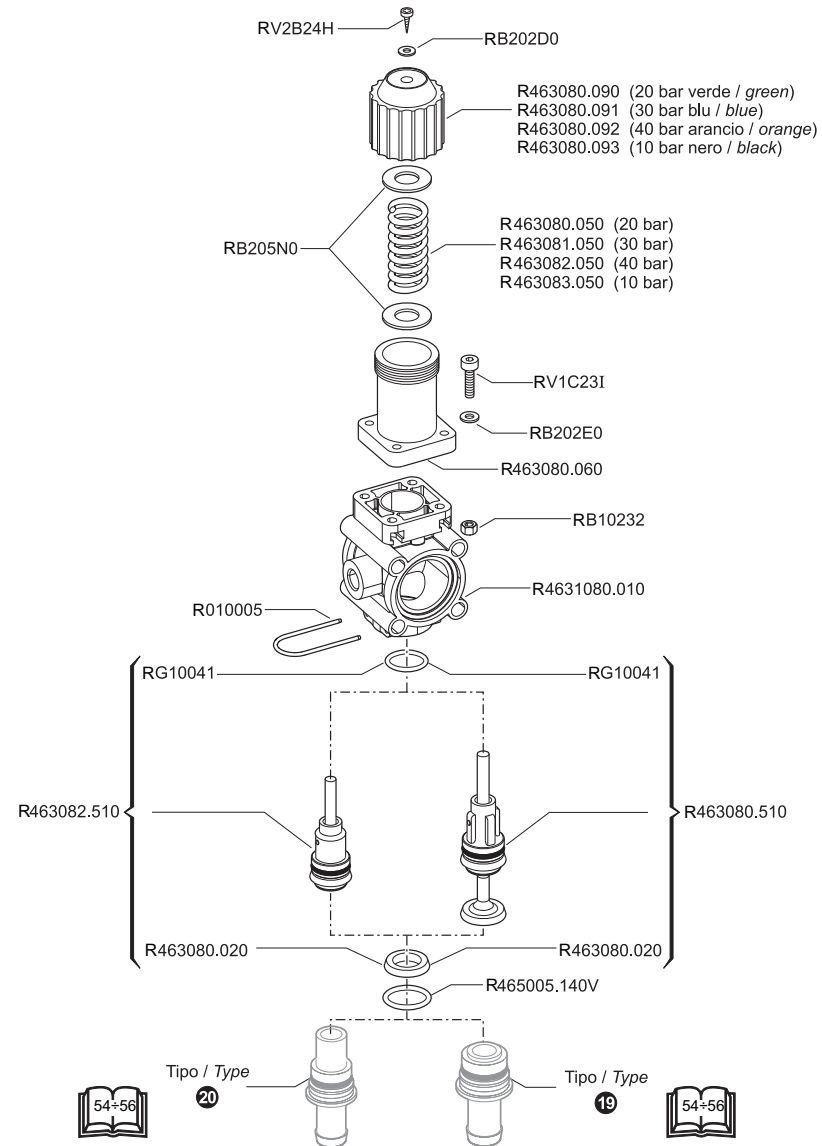

A2 <small>SECTION</small>	TAVOLA 10	CODE R463070 - 463072 - 463074
VALVOLE DI REGOLAZIONE PROPORZIONALI - PROPORTIONAL CONTROL VALVE VANNES DE REGLAGE PROPORTIONELLES - VALVULAS DE REGULACION PROPORCIONAL PROPORTIONAL-REGELVENTILE - VÁLVULAS DE REGULAGEM PROPORCIONAIS		SERIES 463

463070-m04

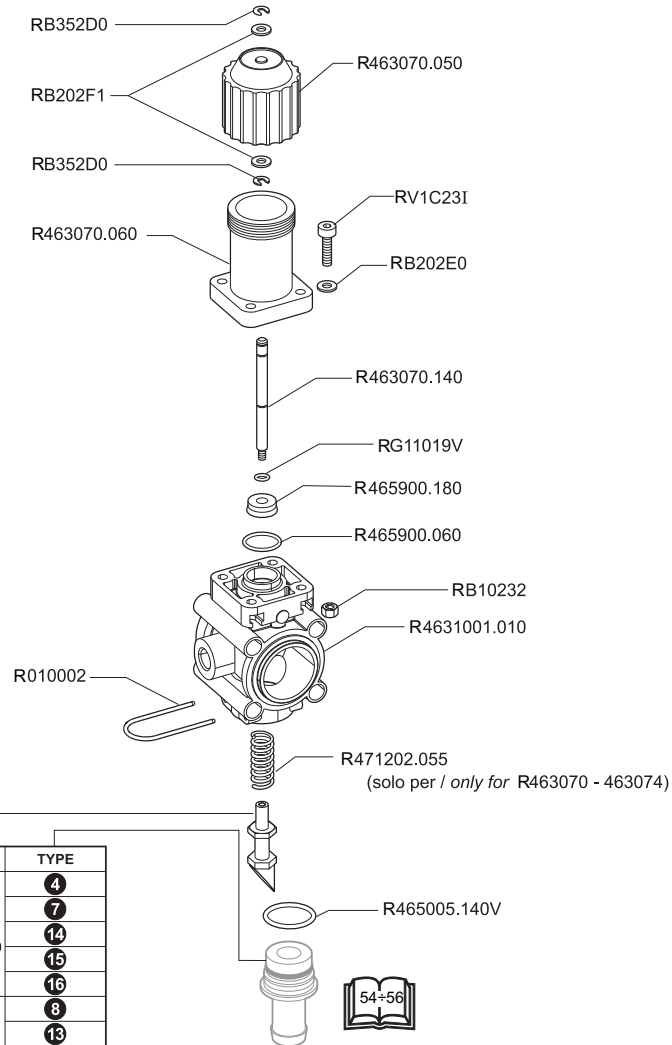

TIPO / TYPE	CODE	TYPE
R463070	R463020.130	4
		7
		14
		15
		16
463072	463022.130	8
		13
463074	463024.130	6
		11

A2 <small>SECTION</small>	TAVOLA 21	463050 - R463051
	VALVOLE SEZIONE DI BARRA - BOOM SECTION VALVES VANNES SECCION DE RAMPE - VALVULAS SECCION DE BARRA TEILBREITENVENTILE - VÁLVULAS DE SEÇÃO DE BARRA	
		SERIES 463

463050-51-m00

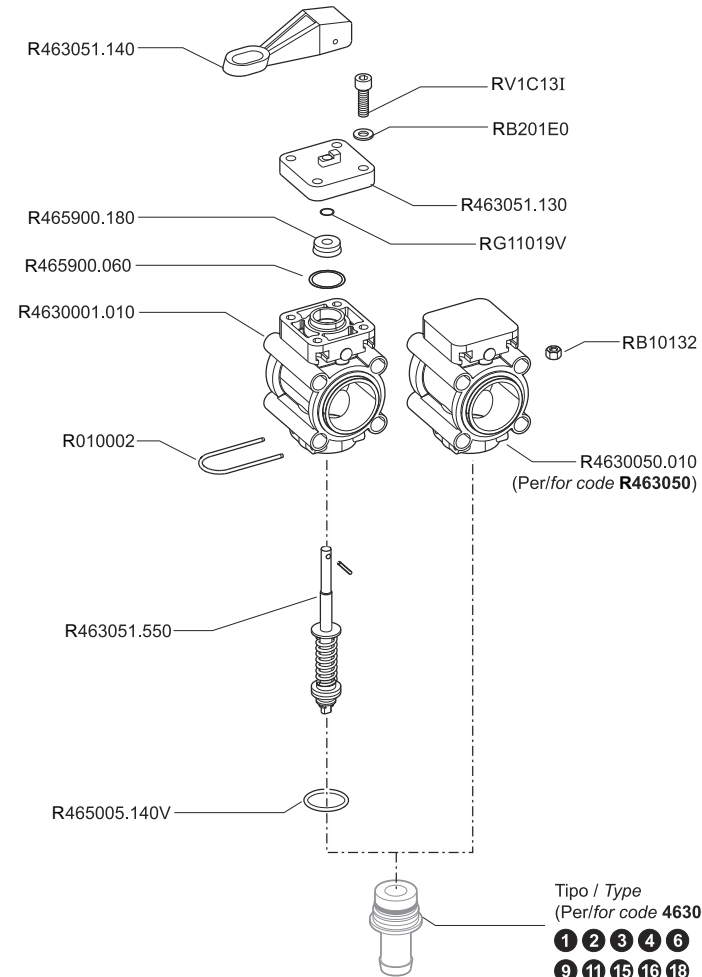

Tipo / Type
(Perfor code **463050**)

- 1 2 3 4 6
- 9 11 15 16 18



Tipo / Type
(Perfor code **463051**)

- 1 2 3 4 7
- 14 15 16 18

A2 SECTION	TAVOLA 25	463001S - R463001HS
	VALVOLE SEZIONE DI BARRA - BOOM SECTION VALVES VANNES SECCION DE RAMPE - VALVULAS SECCION DE BARRA TEILBREITENVENTILE - VÁLVULAS DE SEÇÃO DE BARRA	
		SERIES 463

463001S-001HS-m00

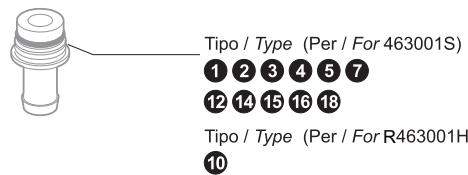
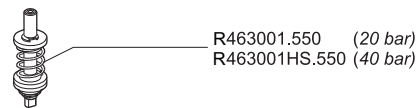
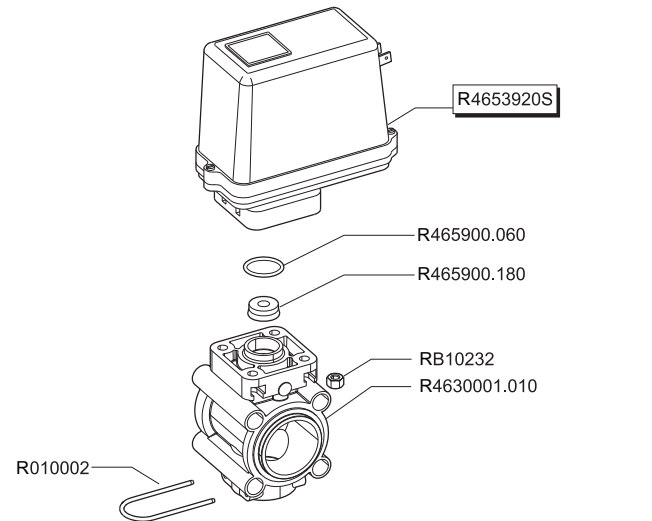

A2 SECTION	TAVOLA 11	COD	R463020 - 463022 - R463024	SERIES
			463020S - 463022S - 463024S	

VALVOLE DI REGOLAZIONE PROPORZIONALI - PROPORTIONAL CONTROL VALVE
 VANNES DE REGLAGE PROPORTIONELLES - VALVULAS DE REGULACION PROPORCIONAL
 PROPORTIONAL-REGELVENTILE - VÁLVULAS DE REGULAGEM PROPORCIONAIS

463020-022-024-020S-022S-024S

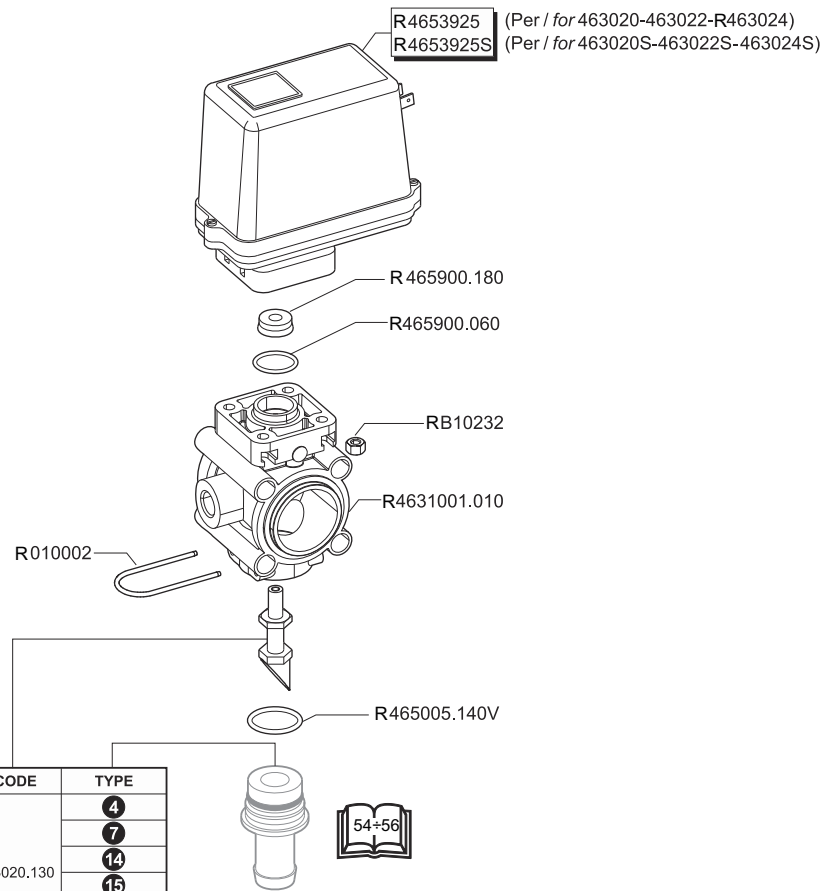

TIPO / TYPE	CODE	TYPE
463020 - 463020S	463020.130	4
		7
		14
		15
		16
463022 - 463022S	463022.130	8
		13
		6
R463024- 463024S	R463024.130	11

A2
SECTION

TAVOLA 27

R3269013 - 32690135

FILTRI IN LINEA FLANGIATI 463 - FLANGED LINE FILTERS FOR 463 SERIES
 FILTRES BRIDES EN LIGNE POUR SERIE 463 - FILTROS EN LINEA PARA BRIDAS 463
 FLANSCH-DRUCKFILTER FÜR SERIE 463 - FILTROS EM LINHA FLANGEADOS POR SERIE 463

SERIES
326

3269013-m00

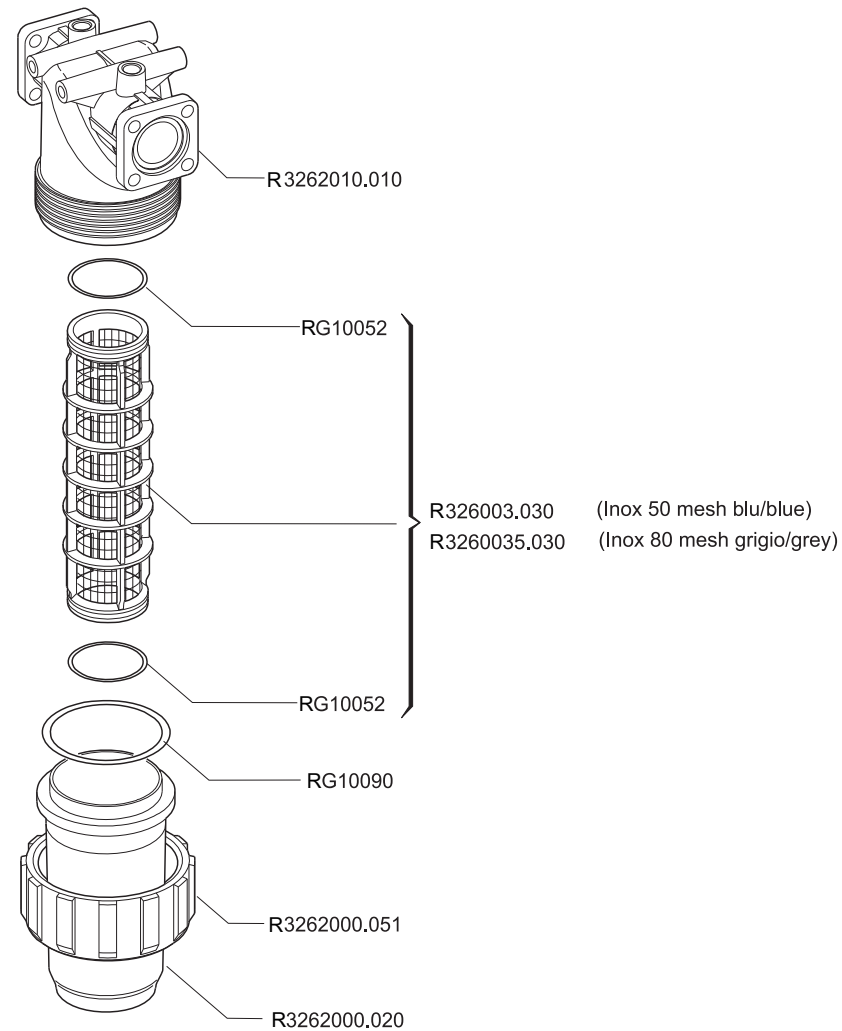

D SECTION	TAVOLA 29	COD 34520020 - 34520030 - R345200350	SERIES 3452

34520020-m00

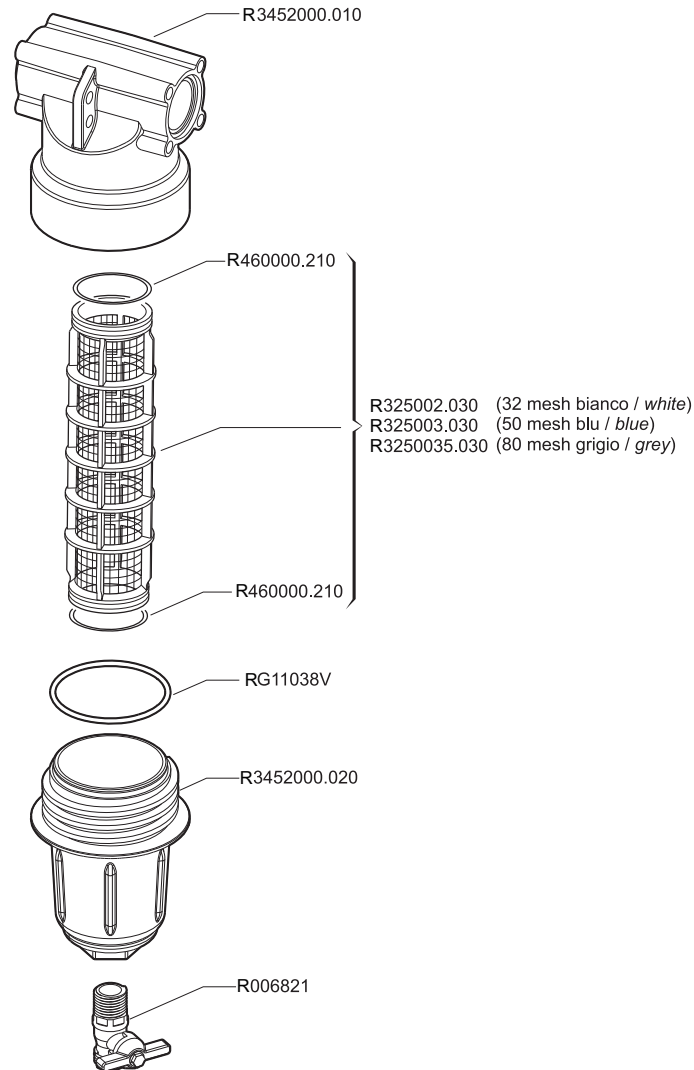

A2 SECTION	TAVOLA 26	COD R463011S - R463011HS
	VALVOLE SEZIONE DI BARRA - BOOM SECTION VALVES VALVULAS SECCION DE BARRA - VANNES SECCION DE RAMPE TEILBREITENVENTILE - VÁLVULAS DE SEÇÃO DE BARRA	
		SERIES 463

463011S_463011HS

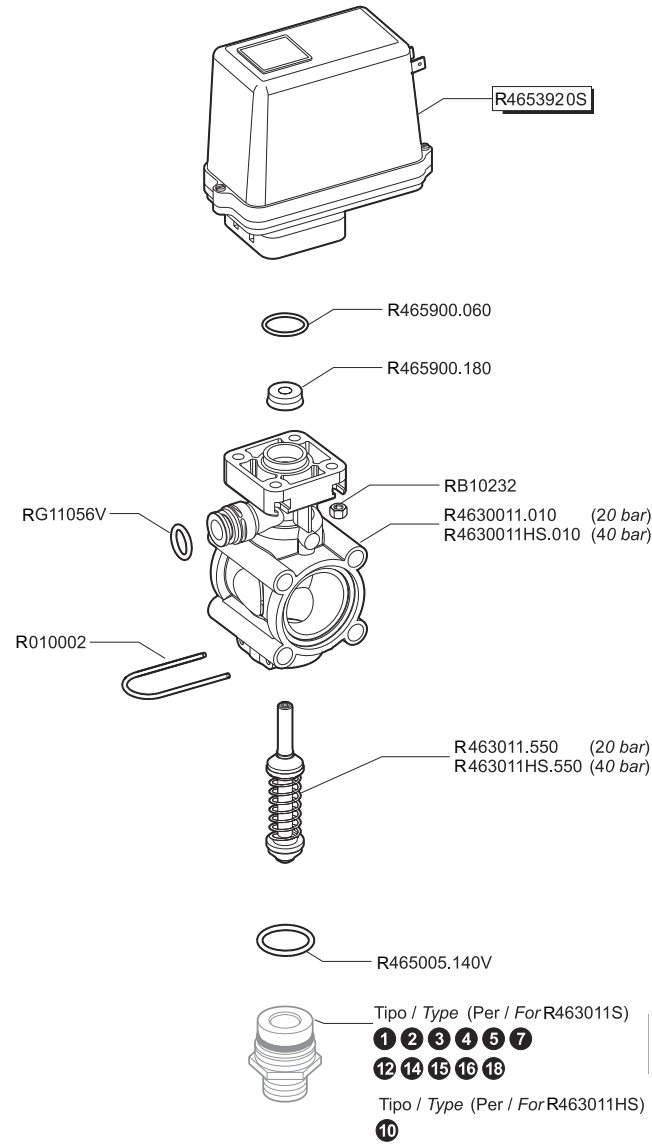

OLD

A2 SECTION	TAVOLA 31	463010.804 - 463010.805 - 463010.820 - 463010.830 - 463010.840
		463010.850 - 463010.860 - 463010.870
COLLETTORI CON VALVOLA DI BILANCIAMENTO - MANIFOLD WITH BALANCING VALVE COLLECTEURS AVEC VANNE DE COMPENSATION - COLETOR COM RETORNO CALIBRADO SAMMLER MIT GLEICHDRUCKVENTIL - COLECTORES DE RETORNO COMPENSADO		SERIES 463

463010_804-m00

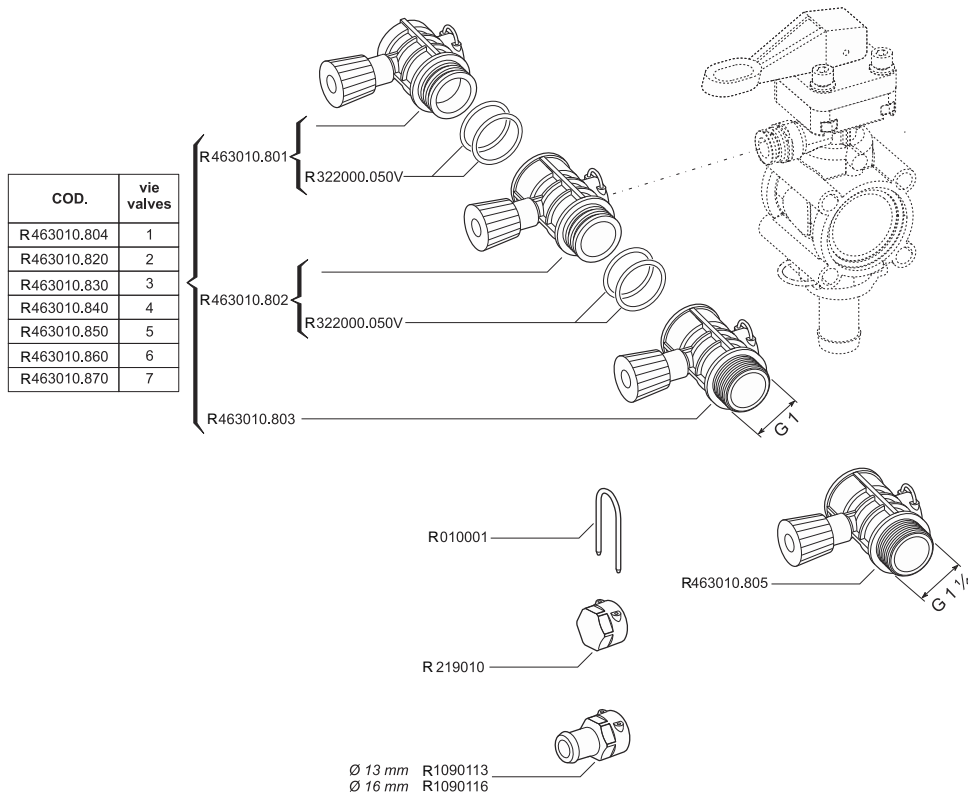

NEW 2006

ACCESSORI DI COMPLEMENTO PER RITORNI CALIBRATI ACCESSORIES FOR METERED BY-PASS ACCESORIOS DE CUMPLIMENTO PARA RETORNOS CALIBRADOS

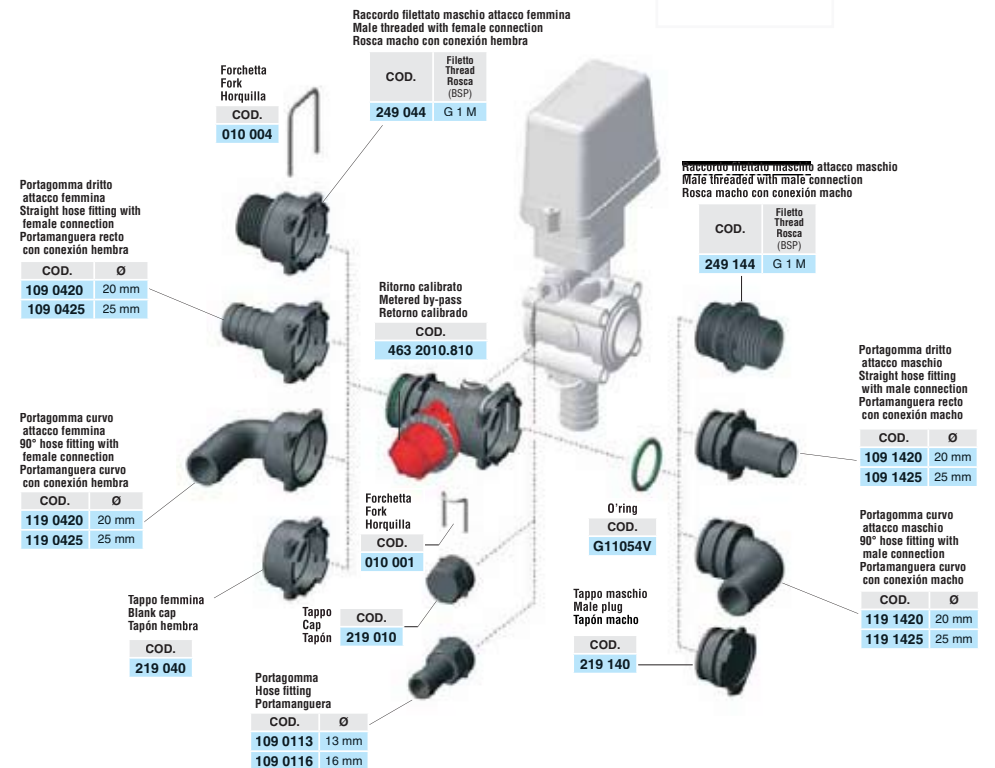







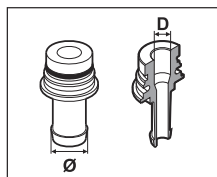

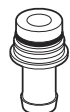
A2 SECTION **TAVOLA 38** COD



ATTACCHI PER VALVOLE - VALVE CONNECTORS
 RACCORDS À VANNES - TOMAS DE SUJECIÓN PARAVÁLVULAS
 ANSCHLUSS FÜR VENTILE - CONEXÕES PARAVÁLVULAS

SERIES

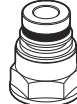

	Codice / Code	Ø	D
	R463001.A10	10 mm - 3/8"	12,5 mm
	R463001.A13	13 mm - 1/2"	12,5 mm
	R463001.A16	16 mm - 5/8"	12,5 mm
	R463001.A19	19 mm - 3/4"	14 mm
	R463001.A19M	19 mm - 3/4"	12,5 mm
	R463001.A25	25 mm - 1"	16 mm
	R463001.A25M	25 mm - 1"	14 mm
	R463022 A13	13 mm - 1/2"	10 mm

	Codice / Code	Ø	D
	R463001.B20	G 1/2 M	12,5 mm
	R463001.B20M	G 1/2 M	10 mm
	R463001.B40	G 1 M	16 mm
	R463001.B40A	G 1 M	12,5 mm
	R463001.B40B	G 1 M	10 mm
	R463001.B40M	G 1 M	14 mm
	R463001.B70	G 3/4 M	14 mm

	Codice / Code	Ø	D
	R463001.B75	G 3/4 F	14 mm
	R463001.B75N	NPT 3/4 F	14 mm



	Codice / Code	Ø	D
	R463001.C13	13 mm - 1/2"	12,5 mm



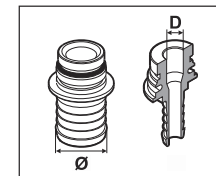

A2 SECTION **TAVOLA 39** COD



ATTACCHI PER VALVOLE - VALVE CONNECTORS
 RACCORDS À VANNES - TOMAS DE SUJECIÓN PARAVÁLVULAS
 ANSCHLUSS FÜR VENTILE - CONEXÕES PARAVÁLVULAS

SERIES







	Codice / Code	Ø	D
	R463080.A19	19 mm - 3/4"	16 mm
	R463082.A19	19 mm - 3/4"	16 mm

	Codice / Code	Ø	D
	R473001.A19	19 mm - 3/4"	20 mm
	R473001.A25	25 mm - 1"	20 mm
	R473001.A30	30 mm	20 mm
	R473001.A32	32 mm - 1" 1/4	20 mm

	Codice / Code	Ø	D
	R473001.B40	G 1 M	20 mm
	R473001.B50	G 1 1/4 M	20 mm

	Codice / Code	Ø	D
	R473001.B45N	NPT 1 F	20 mm

	Codice / Code	Ø	D
	R473001.C25	25 mm - 1"	20 mm

	Codice / Code	Ø	D	Colore / colour
	R464402.A90	25 mm - 1"	--	Blu / blue
	R464402.A91	30 mm	--	Verde / green
	R464402.A92	35 mm	--	Rosso / red
	R464402.A93	38 mm - 1" 1/2	--	Giallo / yellow

A2 SECTION **TAVOLA 40** COD.

ATTACCHI PER VALVOLE - VALVE CONNECTORS
 RACCORDS À VANNES - TOMAS DE SUJECIÓN PARAVÁLVULAS
 ANSCHLUSS FÜR VENTILE - CONEXÕES PARAVÁLVULAS

SERIES

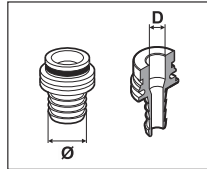

	Codice / Code	Ø	D
	33 R464402.A40	35 mm	16 mm
	34 R464402.A41	35 mm	17 mm
	35 R464402.A42	35 mm	20 mm
	36 R464402.A43	40 mm	25 mm

	Codice / Code	Ø	D	Colore / colour
	37 R471202.A40	25 mm - 1"	12 mm	Blu / blue
	38 R471202.A41	30 mm	16 mm	Verde / green
	39 R471202.A43	32 mm - 1 1/4"	16 mm	Verde / green
	40 R471202.A45	35 mm	19 mm	Rosso / red
	41 R471202.A25	25 mm - 1"	--	Nero / black
	42 R471202.A30	30 mm	--	Nero / black
	43 R471202.A32	32 mm - 1 1/4"	--	Nero / black
	44 R471202.A35	35 mm	--	Nero / black

	Codice / Code	Ø	D	Colore / colour
	45 R471202.B50	G 1 1/4 M	--	Nero / black
	46 R471202.B51	G 1 1/4 M	19 mm	Rosso / red
	47 R471202.B52	G 1 1/4 M	16 mm	Verde / green

	Codice / Code	Ø
	48 R471202.C25	25 mm - 1"
	49 R471202.C30	30 mm

	Codice / Code	Ø	D
	50 R473001.B30	G 3/4	20 mm

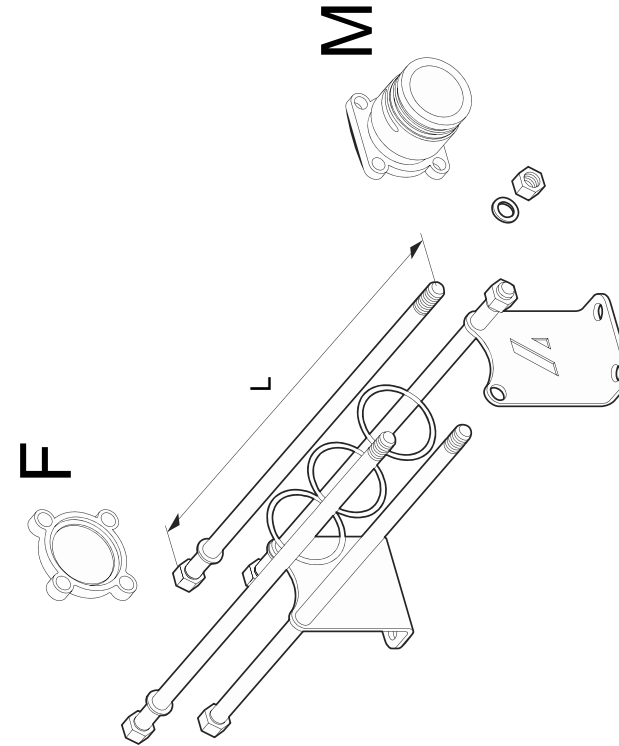

Kit di assemblaggio
 Per completare il gruppo valvole ricordarsi di ordinare sempre una flangia tipo M ed una tipo F (pag. 67).

Assembly kit
 To complete the valve unit always remember to order an M type and F type adapter (page 67).

Kit de ensamblaje
 Para completar el grupo valvulas recuerden pedir siempre una brida tipo M y otra tipo F (pág. 67)

n. valvole-463 n. valves-463 n. valvulas-463	Zincati (*) Galvanized (*) Cincado (*)		Acciaio INOX (**) Stainless Steel (**) Acero INOX (**)		L mm
	COD.	R463 000.910	R463 900.910	R463 900.920	
1	R463 000.910	R463 000.910	R463 900.910	R463 900.920	90
2	R463 000.920	R463 000.920	R463 900.920	R463 900.930	150
3	R463 000.930	R463 000.930	R463 900.930	R463 900.940	207
4	R463 000.940	R463 000.940	R463 900.940	R463 900.950	264
5	R463 000.950	R463 000.950	R463 900.950	R463 900.960	321
6	R463 000.960	R463 000.960	R463 900.960	R463 900.970	378
7	R463 000.970	R463 000.970	R463 900.970	R463 900.980	436
8	R463 000.980	R463 000.980	R463 900.980	R463 900.990	493
9	R463 000.990	R463 000.990	R463 900.990	R463 900.1000	550
10	R463 000.1000	R463 000.1000	R463 900.1000	R463 900.1100	610

F = Flangia con incastrò femmina
 M = Flangia con incastrò maschio

F = Female adapter
 M = Male adapter
 F = Brida hembra
 M = Brida macho

* = Standard su gruppi manuali e per atomizzatori
 ** = Standard su gruppi di comando elettrici

* = Standard on manual & orchard control units
 ** = Standard onelectric control units

* = Standard sobre log grupos manuales y para atomizadores
 ** = Standard sobre los grupos de mando electrico

A1
SECTION

TAVOLA 8

COD. R46615200

SCATOLE DI COMANDO COMPATTE - COMPACT CONTROL BOXES
BOITIERS DE CMDE DE DIM. REDUITES - CAJAS DE MANDO COMPACTAS
KOMPAKT-SCHALTKÄSTEN - CAIXAS DE COMANDO COMPACTAS

SERIES
4661

466150XX-m04

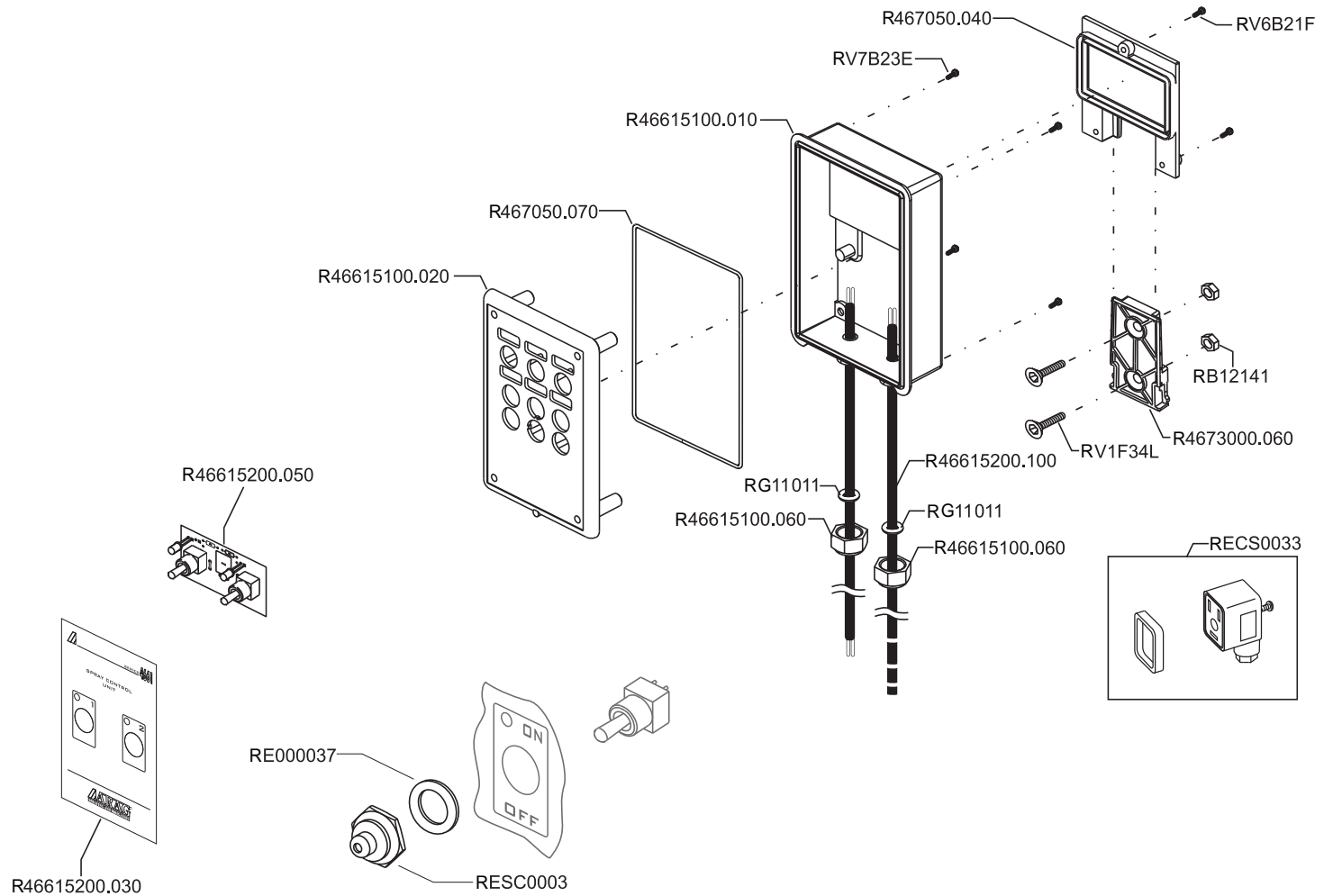

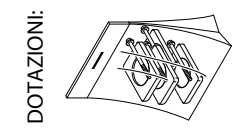
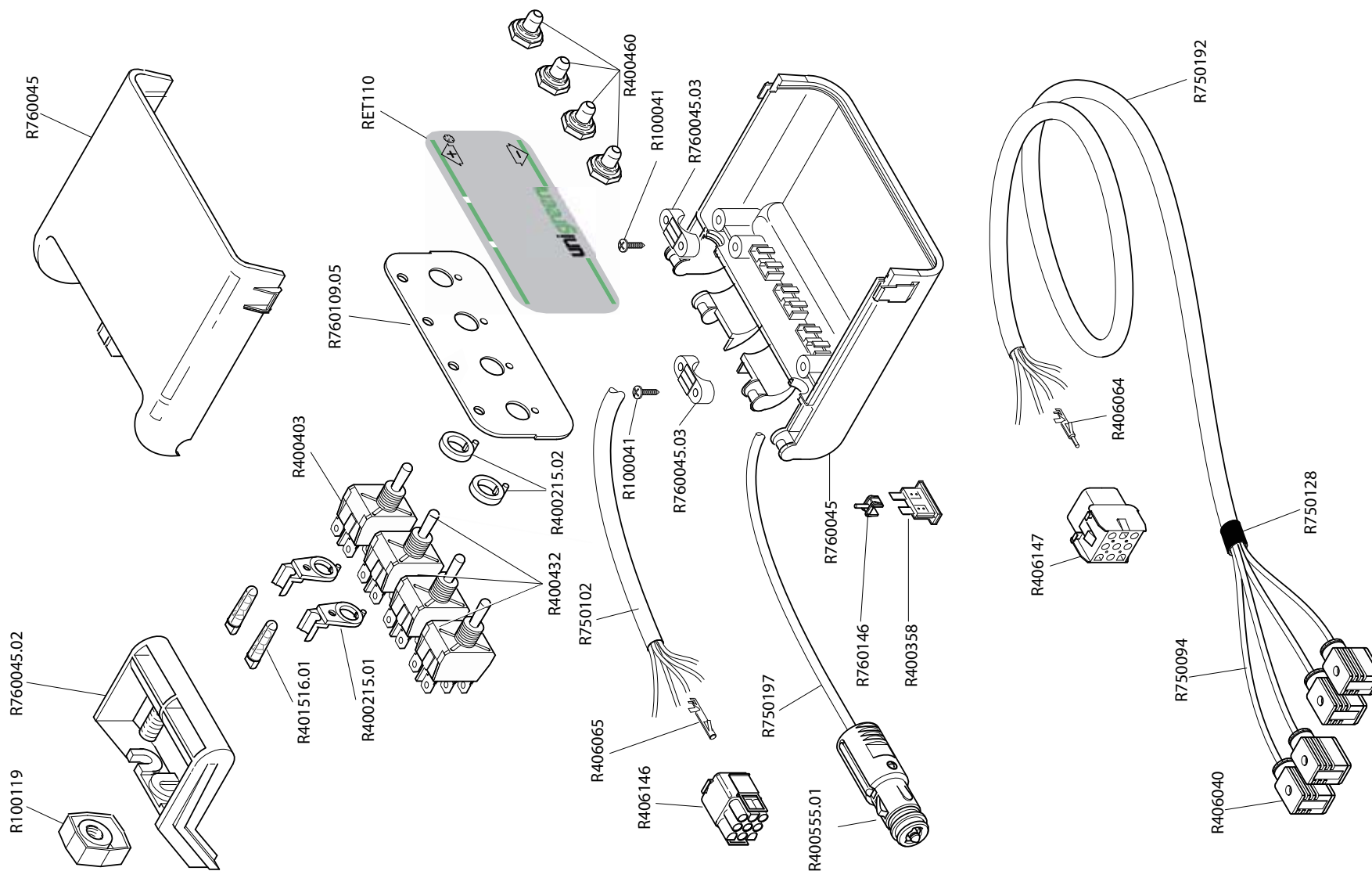

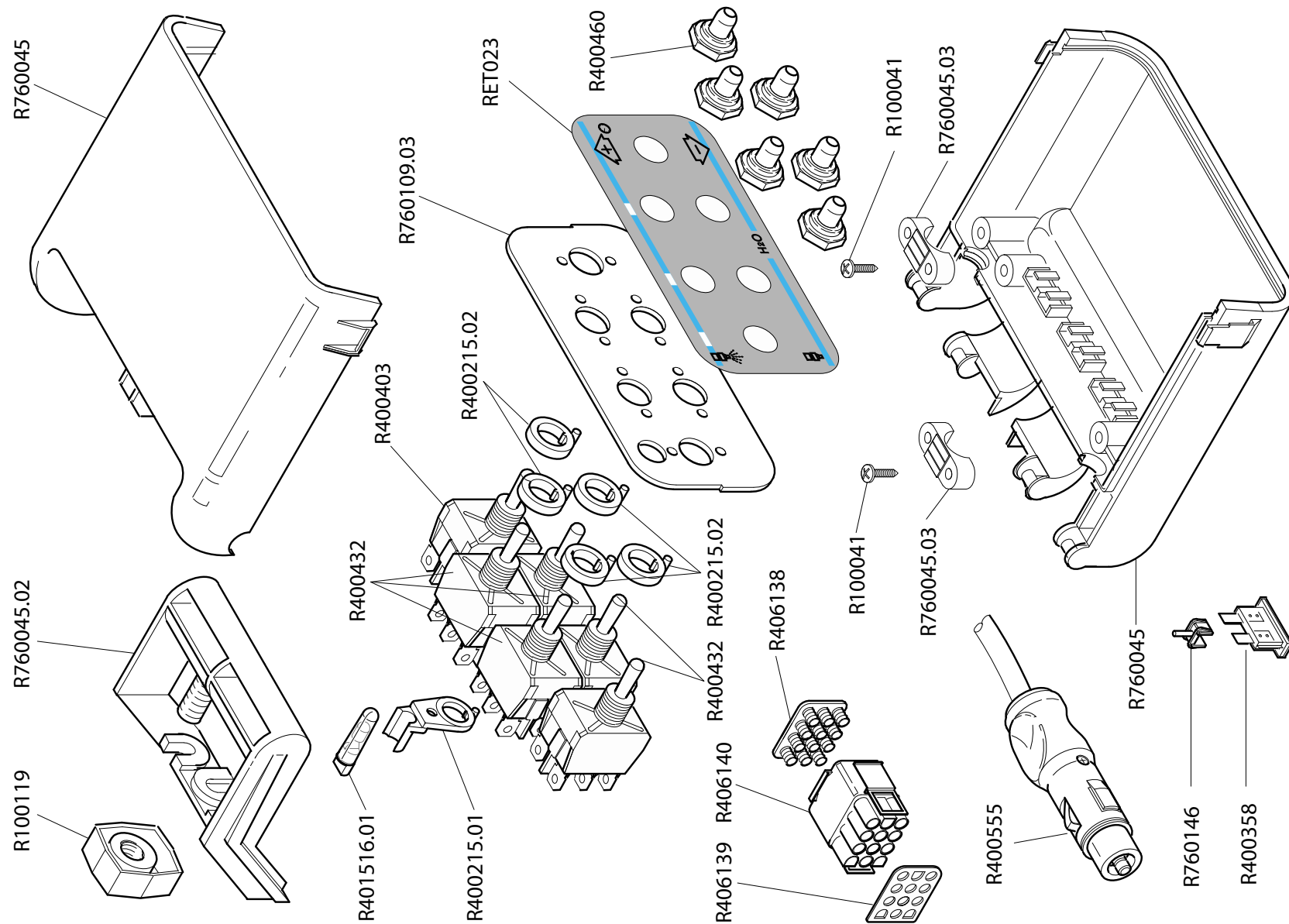

unigreen[®]
S.p.A.
CROP PROTECTION



UNIGREEN[®] S.p.A.

via Rinaldi, 105 - 42100 REGGIO EMILIA - ITALY

Tel. (0039) 0522 369811 - Fax. (0039) 0522 369898

e-mail info@unigreen-spa.com - internet www.unigreen-spa.com

member of the YAMA group